

VAPOR LT1

Floor

120V

1x max 100W QT-DE12 short (R7s)

con./with

6x max 70W Classic A60 (E26)

o/or

6x max 30W CFL (E26)

o/or

6x max Classic A60 LED (E26)

MOUNTING INSTRUCTIONS

- 1) Undo the screws [E] and remove the ring [D]. Then undo the screws [F] and remove the glass [C] (see Fig. 1 and Fig.4)
- 2) Install the light bulbs inside the frame and on top of it [A](Fig.2)
- 3) Place the glass [C] and block it with the screws [F](Fig.4)
- 4) Place the first "blade" [B] on the frame paying attention to insert it on the same slot on the various levels (see Fig. 1 and Fig.3); starting on a slot close to a vertical rod of the frame will make the task easier. Slide down the "blade" to insert the hooks [H] on the appropriate holes. Install the next "blade" using the first as a reference and so on for the remaining "blades".
- 5) Once all the "blades" are in place, close the top compartment [A] placing the ring [D] on top of the glass and fix it with the screws [E]: this way the "blades" will be secured (Fig.5)
Attention: Be careful not to over tighten to avoid damaging the glass.
- 6) Insert the plug.
Note: To replace a light bulb inside the central structure unlock and remove a few blades. It is not necessary to remove all the blades, but just enough to be able to access and replace the faulty light bulb.

Eng

2016.07.21

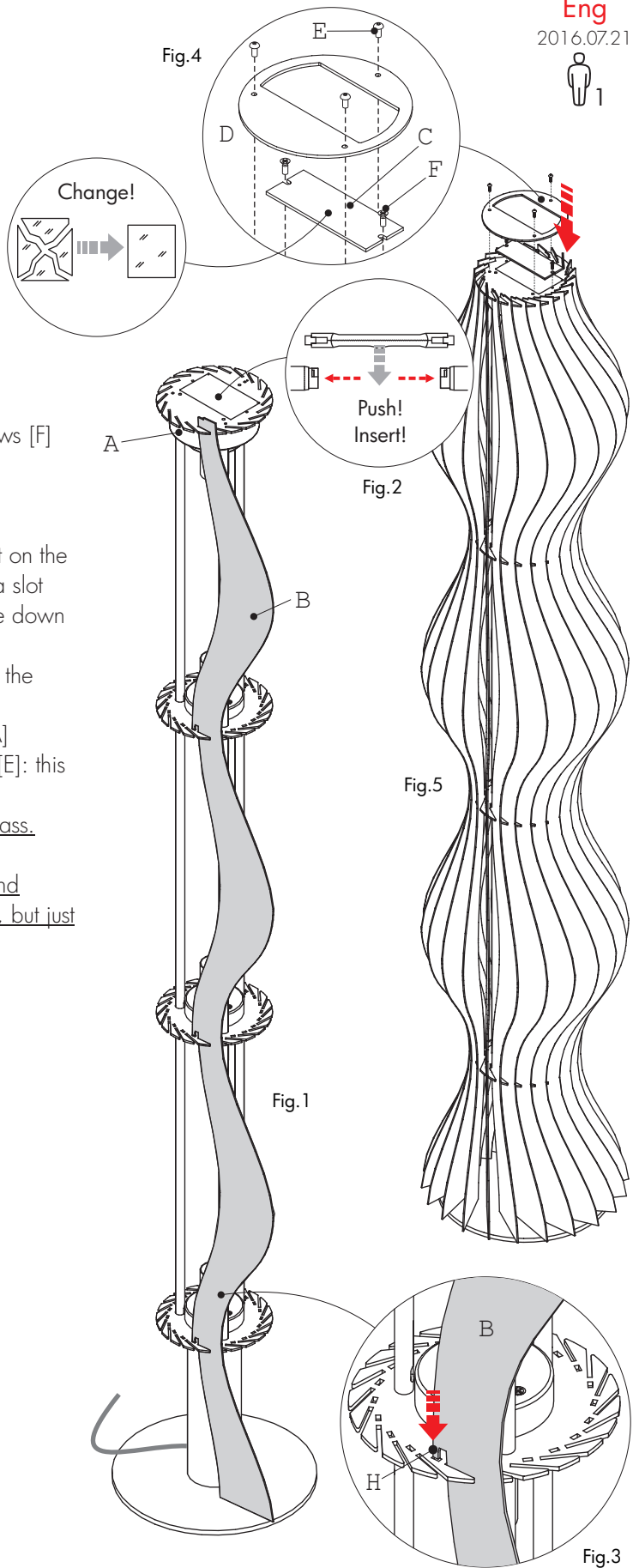

Studio Italia Design warrants its to be free from defects in materials and workmanship for a period of one year date of delivery. During this warranty period Studio Italia Design will repair or replace, at its option, product that are proven to be defective. This warranty does not apply to damages resulting from accidental, alteration, tampering, misuse, negligence or abuse. Any modification may compromise safety causing the product to become dangerous. Studio Italia Design declines all responsibility for products that are modified. Fixture must not be installed in any position or used in a different way than shown in his instructions.

Studio Italia Design garantit que ses produits sont exempts de défauts de matériaux et de fabrication pour une période d'un an à compter de la livraison. Pendant cette période, Studio Italia Design s'engage à réparer ou remplacer, à sa discrétion, les produits considéré défectueux. Cette garantie ne s'applique pas aux dommages résultant d'un accident, modification, altération, d'abus et de négligence. Toute modification peut compromettre la sécurité de celui-ci en le rendant dangereux. Studio Italia Design décline toute responsabilité pour le produit modifiés. Le produit ne peut pas être installé dans un autre position que celle indiqué dans les notice de montage.

**Keep these instructions for future reference
Maintenez ce manuel pour la future référence**

US

STUDIO ITALIA DESIGN | Via Pialoi, 32, 30020, Marcon, Venezia, ITALY | www.studioitaliadesign.com | info@studioitaliadesign.com